

TESTA<sup>med</sup><sup>®</sup>

DIABETES CARE

**GlucoCheck**  
— ADVANCE —

Blutzuckermessgerät  
Kan Glüközü İzleme Sistemi

**Kurzanleitung /  
Hızlı Başlangıç  
Kullanıcı Kılavuzu**

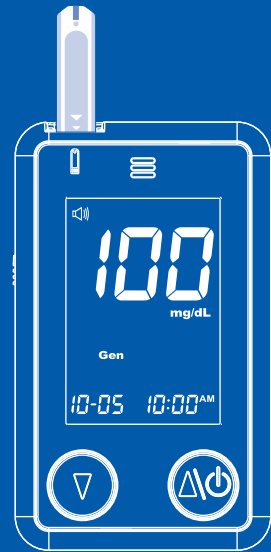

Vertrieb / Dağıtım:  
Maurer Pharma GmbH  
Postfach 12 20, 56136 Boppard-Bad Salzig  
Germany

Sie haben noch Fragen?  
Rufen Sie uns kostenfrei\* an:  
0800-TREND 11 (0800-87363-11)

\* Nur kostenlos bei Anruf aus dem deutschen Festnetz.

TESTAMED Müşteri Hizmetleri Yardım Hattı:  
0800 TREND11 ( 0800-87363-11 )  
www.testamed.de

BioCare Corporation  
4F, No. 12, Lane 5, Sec. 2, Nanshan Rd.,  
Luzhu Dist., 33852 Taoyuan City, TAIWAN

MedNet GmbH  
Borkstraße 10, 48163 Münster, Germany



Zur Selbstkontrolle. / Kendi kendine test içindir.  
315-428930-002

Einstellung der Messeinheit /  
Ölçüm Biriminin Ayarlanması

1

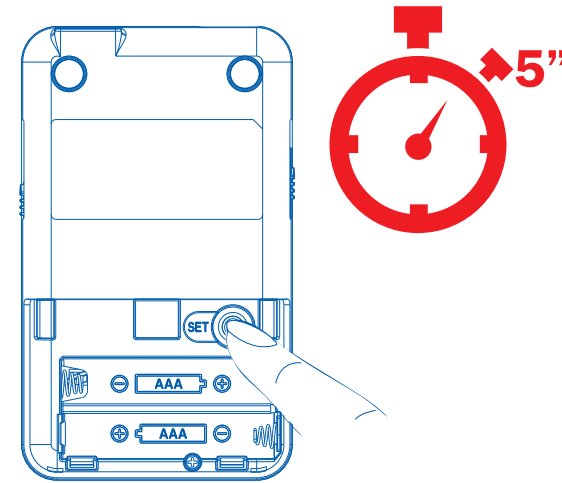

2

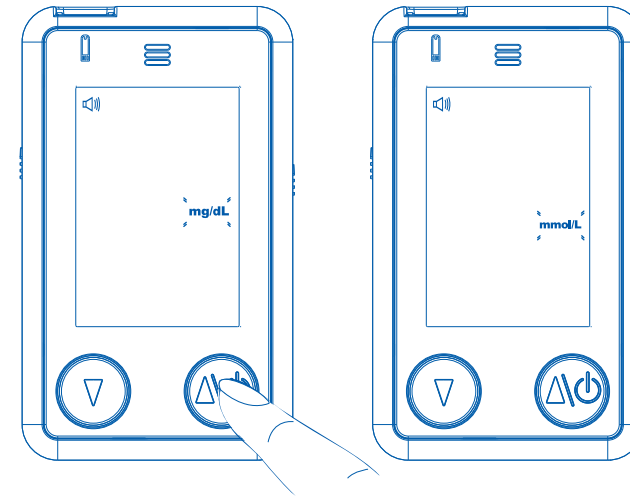

3

3.1

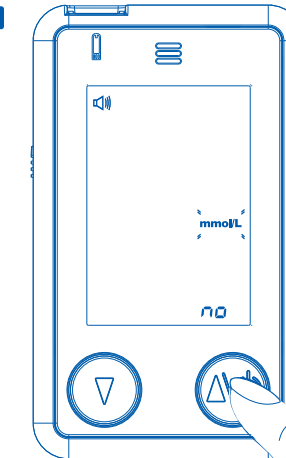

3.2

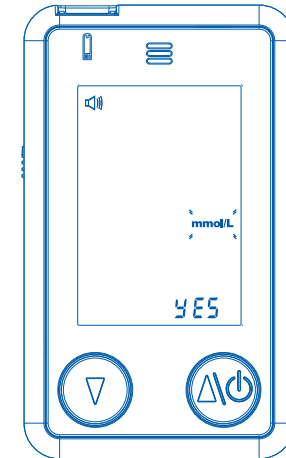

3.3

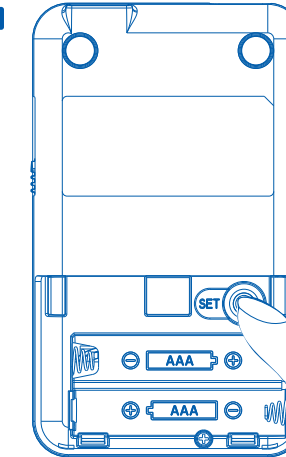

3.4



GRUNDEINSTELLUNG DES MESSGERÄTES /  
ÖLÇÜM CİHAZININ AYARLANMASI

2

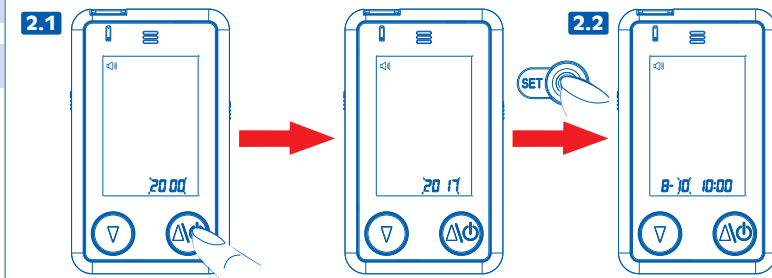

2.2

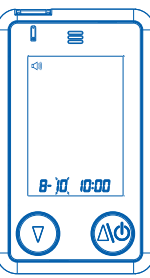

3

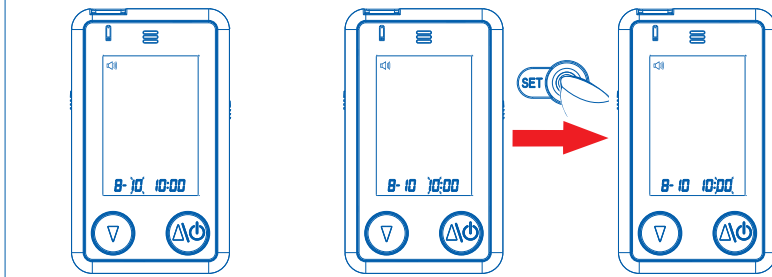

4

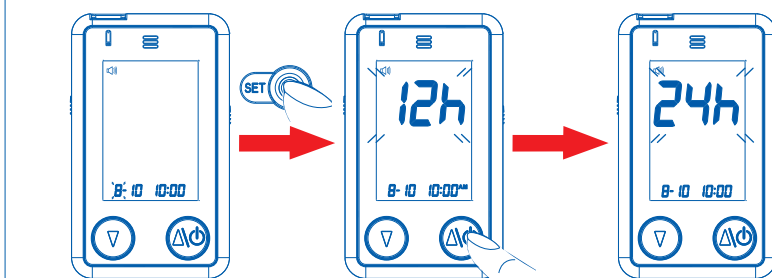

5

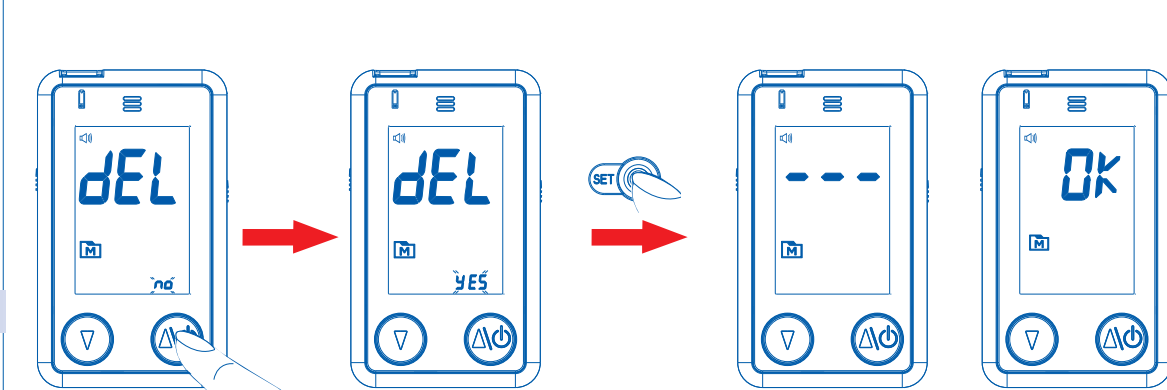

6

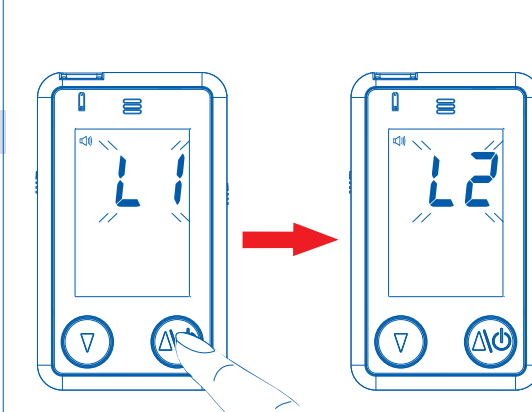

7

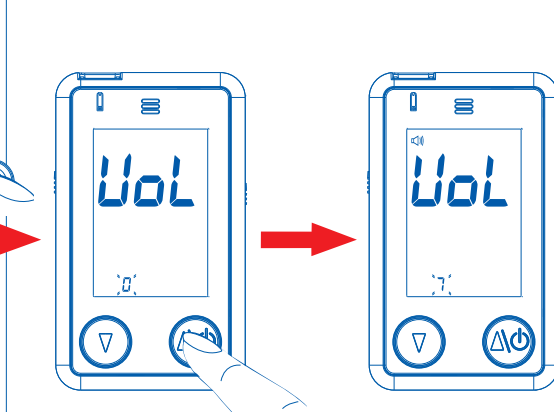

8

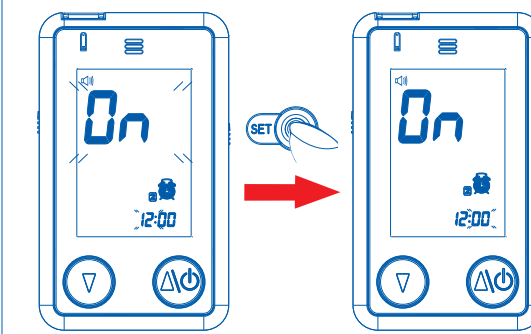
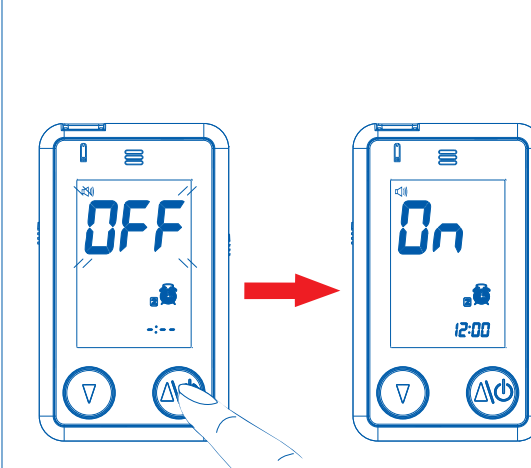

1

